

The NATIONAL TIME digital clock protective guard is superior to other models. Manufactured with heavy duty 18 gauge steel, this guard will stand up to the most demanding installations. The tough polycarbonate window provides obstruction-free viewing of the clock not found in wire guard versions. The slanted angle of the front matches the angle of the clock cases and helps reduce glare from overhead lighting.

The guard is available in two depths. The Semi-flush model will cover clock installations using flush mounted electrical boxes. The Surface model is taller and provides knock-outs on each side to accommodate a digital clock surface box and surface mounted wiring conduit.

These Clear-View Guards will protect National Time's 2.25" four or six-digit clocks as well as 4" four-digit clocks. The guards are finished with Powder Gray paint to match the standard digital clock finishes. Other colors are available upon request.

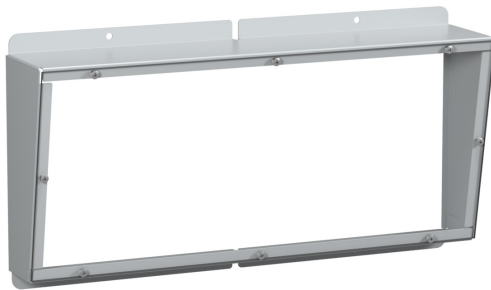

**CV-GUARD-SF-SL**



**CV-GUARD-S-SL**

## Features:

- Durable Welded Steel Housing
- Tough Polycarbonate Window
- Obstruction-Free Viewing
- Surface and Semi-flush Models
- Protects up to 4" Four-digit Clock
- Easy Installation

## Model CV-GUARD-SF (Semi-Flush)



Model CV-GUARD-SF

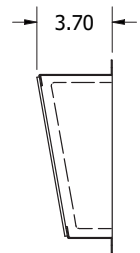
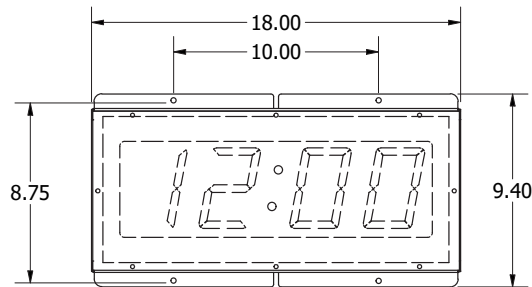
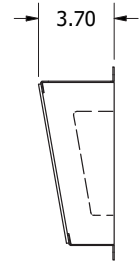
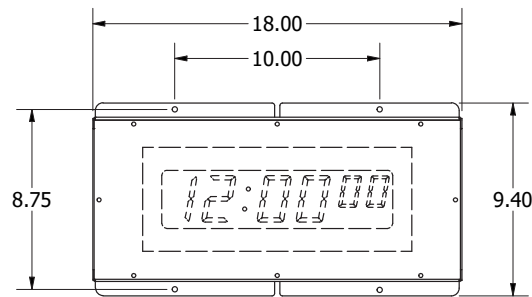

## Model CV-GUARD-S (Surface)

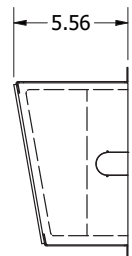
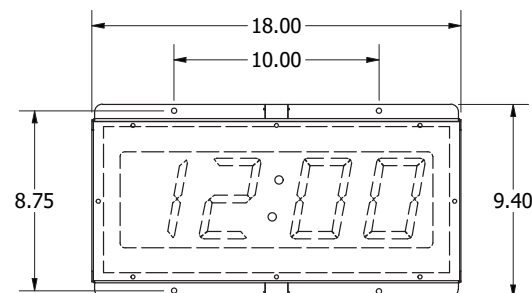
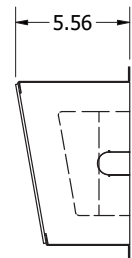
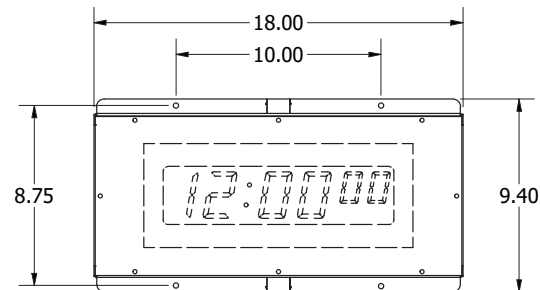

Appropriate mounting hardware for wall construction type should be used. (Not included)

## Ordering Information

Part No.	Description
CV-GUARD-SF-SL	Clear View Guard for DTC/DW Semi-Flush Digital Clocks - Slanted
CV-GUARD-S-SL	Clear View Guard for DTC/DW Surface mounted Digital Clocks - Slanted